

INLINE DEIONIZED WATER HEATERS

PATENTED
SEALING
TECHNOLOGY

HIGH PURITY
FLOW PATH

SERIES OR
PARALLEL
CONFIGURATION

NO PURGING
REQUIRED



3-6 kW Heater

18 kW Heater



MAX TEMPERATURE
100 °C / 212 °F



MAX PRESSURE
80 PSI / .55 MPa



CERTIFICATIONS
CE, Semi S2



12 kW Heater

Heating modules may be combined to achieve desired capacity and plumbing.

Trebor's Inline Deionized Water Heaters utilize the same reliable and efficient heating technology featured in our deionized water and inline chemical heaters. Our thin film on quartz, electric resistive technology sets us apart from other heating technology because of the combination of a high purity fluid path, a quick ramp up time and crevice free design. This heater is well-suited as a plug and play option for a variety of applications and processes, especially with fluids that need to be heated quickly, and for point of use systems. The Inline Deionized Water Heater was designed to be a scalable solution for heating pure water in tight spaces, so plumbing and sizing can be customized for your system.

This is PURE INNOVATION.

TREBOR

Trebor International | North/South America +1 800 669 1303 | Europe +49 9120 1804-65 | Asia +65 6684 7319

treborintl.com

A Unit of IDEX Corporation

HEATER OPTIONS

MODEL	IDA	Deionized Water Heater ≤100° C ≥ 2 LPM
	IDB	Deionized Water Heater ≤100° C ≤ 2 LPM
	IDH	Deionized Water Heater ≤100° C ≥ 2 LPM
CONFIGURATION	03V208S 3kW, 208 VAC, Single φ 03V400Y 3kW, 400 VAC, 3 φ Wye 04V208S 4kW, 208 VAC, Single φ 04V400Y 4kW, 400 VAC, 3 φ Wye 06V400S 6kW, 400 VAC, Single φ 06V400D 6kW, 400 VAC, 3 φ Delta 18V400D 18kW, 400 VAC, 3 φ Delta ** IDH Model Only	
FLUID CONNECTION	F04 1/4" Flare F06 3/8" Flare ** IDH Model Only F08 1/2" Flare F12 3/4" Flare X04 1/4" Super 300 Pillar X08 1/2" Super 300 Pillar X12 3/4" Super 300 Pillar	
LEAK SENSOR	A N/O 24 vdc Conductive B N/C 24 vdc Conductive	
OVER-TEMP SAFETY SENSORS	A J-Type T/C B PT1000 (RTD) C PT100 (RTD)	

Example of an order number based on configuration options:

IDA 03V208S F12 A B

LIQUID LEVEL SENSORS

DP-L-51	Capacitive Clip On
DP-L-52	Optical Clip On

Optional Liquid Level Sensors
(Sold Separately)

3-6 kW Heater

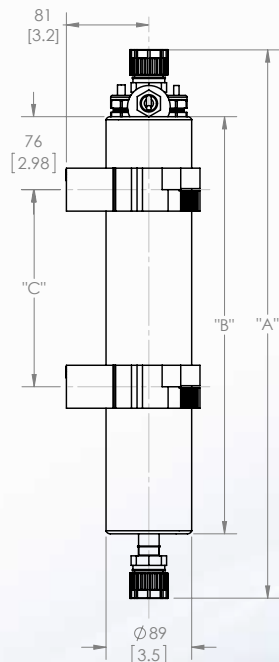

Use 2X Ø8mm-12mm [3/8"-7/16"] bolts with washers to fixture each clamp to wall

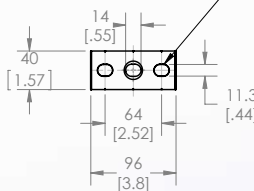

	HEIGHT (mm [in])			WEIGHT (kg [lbs])
	"A"	"B"	"C"	
6kW	738 [29.0]	605 [23.8]	51-373 [2.0-14.7]	5.63 [12.4]
3kW & 4kW	569 [22.4]	433 [17.1]	51-203 [2.0-8.0]	4.26 [9.4]

DIMENSIONS IN MILLIMETERS (IN.)

18 kW Heater

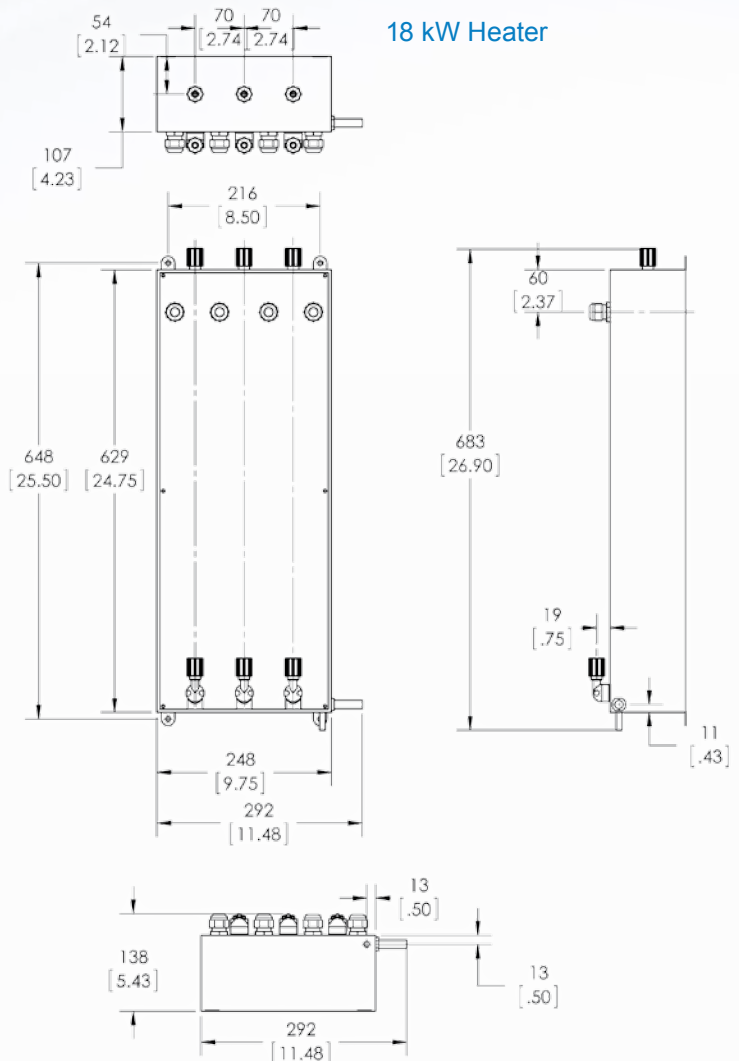

Trebor uses virgin PTFE and PFA in all products...no re-processed material is allowed.

Trebor International | North/South America +1 800 669 1303 | Europe +49 9120 1804-65 | Asia +65 6684 7319

TREBOR®

treborintl.com

A Unit of IDEX Corporation

© Copyright 2016 Trebor, Inc. All rights reserved. IDH_DS_REV0316