

# INLINE CHEMICAL HEATERS

**PATENTED  
SEALING  
TECHNOLOGY**

**HIGH PURITY  
FLOW PATH**

**SERIES OR  
PARALLEL  
CONFIGURATION**

**NO PURGING  
REQUIRED**



*Heating modules may be combined to achieve desired capacity and plumbing.*

Trebor's Inline Chemical Heaters are unlike any other heating technology on the market because of our thin film on quartz electric resistive technology. Our technology, combined with high-purity materials, a quick ramp up time, crevice-free design, and customizable configurations, creates reliable and efficient heater. Because of the design simplicity and flexibility, we can accommodate a wide range of application needs with only two models – a high temperature version and a low temperature version. These heaters are well-suited as a plug-and-play design for a variety of applications, especially with fluids that need to be heated quickly and at point-of-use.

***This is PURE INNOVATION.***



**MAX TEMPERATURE**  
100 °C / 212 °F ICA  
200 °C / 392 °F ICB



**MAX PRESSURE**  
80 PSI / .55 MPa



**CERTIFICATIONS**  
CE, Semi S2, Semi S3

**TREBOR**

Trebor International | North/South America +1 800 669 1303 | Europe +49 9120 1804-65 | Asia +65 6684 7319

[treborintl.com](http://treborintl.com)

A Unit of IDEX Corporation

## HEATER OPTIONS

MODEL	ICA Chemical Heater $\leq 100^{\circ}\text{C}$ $\geq 2$ LPM
	ICB Chemical Heater $\geq 100^{\circ}\text{C}$ $\leq 2$ LPM
CONFIGURATION	03V208S 3kW, 208 VAC, Single $\phi$
	03V400Y 3kW, 400 VAC, 3 $\phi$ Wye
	04V208S 4kW, 208 VAC, Single $\phi$
	04V400Y 4kW, 400 VAC, 3 $\phi$ Wye
	06V400S 6kW, 400 VAC, Single $\phi$
	06V400D 6kW, 400 VAC, 3 $\phi$ Delta
FLUID CONNECTION	F04 1/4" Flare
	F08 1/2" Flare
	F12 3/4" Flare
	X04 1/4" Super 300 Pillar
	X08 1/2" Super 300 Pillar
	X12 3/4" Super 300 Pillar
LEAK SENSOR	A N/O 24 vdc Conductive
	B N/C 24 vdc Conductive
OVER-TEMP SAFETY SENSORS	A J-Type T/C
	B PT1000 (RTD)
	C PT100 (RTD)

Example of an order number based on configuration options:

ICA 03V400Y F12 A B

### LIQUID LEVEL SENSORS

DP-L-51	Capacitive Clip On
DP-L-52	Optical Clip On

Optional Liquid Level Sensors  
(Sold Separately)

### HIGH PURITY FLUID PATH

Fluid path constructed entirely of GE 214 Quartz, PTFE and PFA

### PATENTED FLUID PATH TECHNOLOGY

Eliminate potential leak point with no elastomer o-rings

### LOW THERMAL MASS

Allows faster ramp to temperature

### VERTICAL ORIENTATION

Eliminates dead leg and particle traps

### SEALED, PFA/PTFE ENCLOSURE

Reduces the risk of element failure from environment



### THIN FILM RESISTOR

Single or three phase power allows versatility

### QUARTZ ELEMENT WITH THERMOCOUPLES

No IR bulbs or coils to replace

### SAFETY

- Interlocks
- Element over-temperature
- Glass over-temperature
- Leak sensor
- Liquid level sensor

### OPTIONS

- PT100/PT1000 RTD
- Capacitive Fluid Sensor
- Pillar Super 300 Fluid Connection
- Multiple other fluid connections

## DIMENSIONS IN MILLIMETERS (IN.)

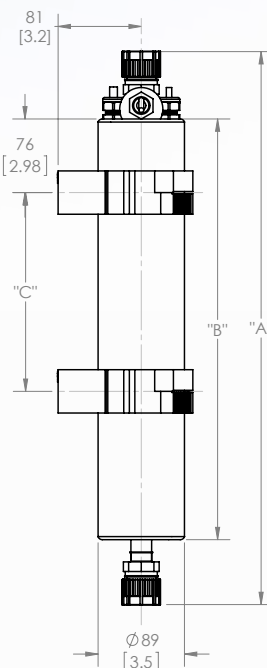

### 3-6 kW Heater

Use 2X  $\phi 8\text{mm}$ -12mm [3/8"-7/16"] bolts with washers to fixture each clamp to wall

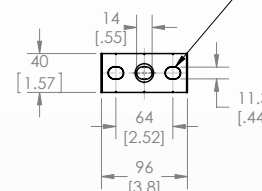

	HEIGHT (mm [in])			WEIGHT (kg [lbs])
	"A"	"B"	"C"	
6kW	738 [29.0]	605 [23.8]	51-373 [2.0-14.7]	5.02 [11.07]
3kW & 4kW	569 [22.4]	433 [17.1]	51-203 [2.0-8.0]	3.88 [8.55]

### MANIFOLD OPTIONS

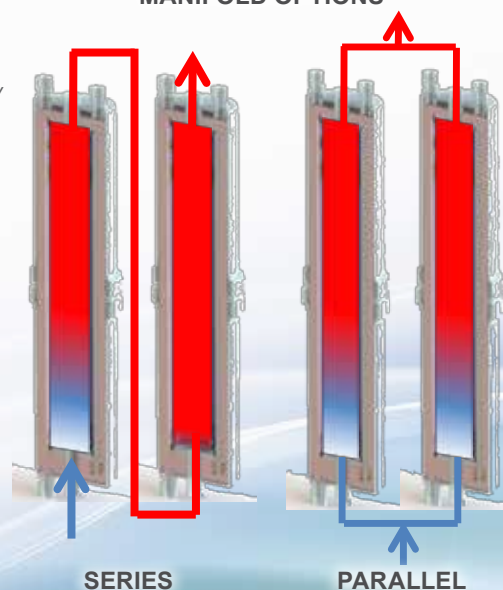

Trebor uses virgin PTFE and PFA in all products...no re-processed material is allowed.

Trebor International | North/South America +1 800 669 1303 | Europe +49 9120 1804-65 | Asia +65 6684 7319